

बीरबल साहनी पुरावनस्पती विज्ञान संस्थान, लखनऊ

BIRBAL SAHNI INSTITUTE OF PALAEOBOTONY

ठेलीग्राम : पेलियोबॉटनी

दूरभाष : 2740008, 2740011

फैक्स : 91-522-2740485, 2740098

बी.सा.पु.सं. II/भवन एवं निर्माण No. II/W&B/BSIP-2015-16/C-708

53, विश्वविद्यालय मार्ग,  
लखनऊ - 226007

Date: 11-09-2015

**Subject: - Quotation for the Modular workstations for computational work in  
the new TL/OSL & Geochemistry Lab**

Dear Sir,

We are interested in purchase of the articles mentioned above, Please send your quotation in sealed covers so as to reach this office of or before 21.09.2015 While submitting quotation please note that :-

1. We are interested in the material from manufacturer.
2. The price quoted should be F.O.R. Destination.
3. Your rates should include packing, insurance and forwarding charges.
4. The rates of Sales Tax/VAT/Service Tax should be clearly indicated wherever chargeable. The Quotation should also indicate Central/Sales Tax Registration Number/PAN and date in this quotation.
5. Specific mention should be made whether the offer is for supplies available ex-stock. In case the officer is on Forward Delivery basis, firm delivery period must be indicated.
6. The cover should be sealed and subscribed "Quotation for above must be written on envelope. Date of opening Next day. The quotations not complying the procedure will be rejected.
7. Payments will be made by crossed cheque on The Indian Overseas Bank, Lucknow only after receipt of the material in good condition.
8. The acceptance of the quotation will rest with the Director who dose not bind himself to accept the lowest quotation and reserves the right to himself to reject or partially accept any or all the quotation received without assigning any reasons.
9. The quotations are liable to be cancelled if any of the above mentioned conditions are not complied with.

Yours faithfully

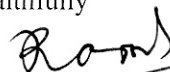

(Ram Shukla)

Registrar

# SPECIFICATION FOR MODULAR WORKSTATION

Sl. No.	Description	Qty.	Rate	Amount
	<p><b>Providing &amp; Fixing Modular Individual Work Station of size 1500x1500x1350 (LXWXH) L type and having curvilinear top of size 1500x1500x600 at 600 mm from the base, One pedestal 3 drawer unit, Key Board Tray, one paper tray, one file holder, one foot rest, one tumbler stand and one glass rack at 300 mm from the table top above the drawer side (light blue area in the diagram attached) as per specification below of each items</b></p>	7 nos.		
1.	<p>Providing and fixing low height <b>PANEL BASE Modular</b> partition of thickness 60 mm thick +/- 2 mm made out of <b>16 gauge extruded aluminum</b> and should have clear space for electrical &amp; data cabling. The height of partition may be varying but not more than 1500 mm. All metallic parts shall undergo a 7 stage antirust treatment and shall be powder coated in matt finish to a thickness of 40-60 microns. All the hardware items should be as BIFMA/ANSI standard. All other items as per IS standards.</p> <p>The modular partition shall be frame and panel base system.</p> <p>Each frame shall be provided with two 12.0mm leveling bolt which allow 50mm adjustment for floor unevenness. The levelers shall be concealed inside the skirting and shall be completely retracted inside the skirting in case of uniformly flat floors.</p> <p>The frames shall be connected at the junctions by aluminum connectors. The junction of frames shall be snap fitted with square post. The post shall be made of aluminum extrusion of 1.2 mm thickness.</p> <p>The Partition frame shall be panel base covered both side laminated or fabric (pinup/magnetic) or glass or white board mounted on soft be attached to the partition frame with clip on the rear surface for easy remove ability/Fix ability (without nails). Both raceways should be hinged type allowing for easy access/facilitating the fixing of boxes and switches/sockets/wiring for electrical/telephone/LAN etc.</p> <p>The ends of race ways shall be slotted for passage of cables/wires the raceways are easily open able without dismantling the complete partition system.</p>			
2.	<p>Supply and fixing table top of shape as per drawing and size as follow.</p> <p>a) Curvilinear 1500x600x1500x600</p> <p><b><u>SPECIFICATION</u></b></p> <p>Each work station shall have the table top made out of 25 mm thick particle board of Grade-II, Type-II confirmation to IS-12823-1990 with phcnolformal- dehyde synthetic resin covered with 1mm thick superior machine pressed PVC edge banding on all the four edges. A balancing laminate shall be provided on the underside of the work surface to prevent warping. The work surface shall be provided with cutouts with grommet covers. The table top shall be fixed to the partition by dowel pins/minifix and supported on MS brackets. 14 gauge.</p>			

	Key board and pull out tray (minimum size 550mmx230mm). <b><u>SPECIFICATION</u></b> It should be made up of 18 gauge metal sheets with adjustable brackets for height adjustment and metal mouse pad flexible to be used on the right or left side. Metal should be approved colour powder coated with power coating not than 40 microns. Ebco make			
5.	<b><u>GLASS HOLDER</u></b> <b><u>SPECIFICATION</u></b> Made of high quality 'A' Grade plastic of Ebco make			
5.	<b><u>DRAWER UNIT</u></b> <b><u>SPECIFICATION</u></b> It should be 3-Dr. Drawer pre laminate board of 18 mm and top of drawer should be 25 mm, it should provide for 2 Nos. box drawers and 1 No. filling drawer. The drawers should be mounted on superior quality double extension telescope ball slides. The drawers should be of lockable type and lock used should be provision for height adjustment of + - 10 mm in case of uneven flooring. Either handles should be provided for recessed edge of the drawers to serve as handles. The Overall. Dimension to be approximately 404 mm x485 mm x650 mm.			
6.	<b><u>PAPER TRAY:</u></b> <b><u>SPECIFICATION</u></b> Made of CRCA steel perforated sheet duly powder coated provision to fix on modular partition as per image attach.			
7	<b><u>FILE Holder:</u></b> <b><u>SPECIFICATION</u></b> Made of CRCA steel perforated sheet duly powder coated provision to fix on modular partition for keeping 4 nos. file as per image attach.			
8.	<b><u>FOOT REST:</u></b> <b><u>SPECIFICATION</u></b> Made of PLPB Board of Size 600x450x120 mm with all exposed edge covered by PVC lipping			
	<b><u>TOTAL</u></b>			

# VAT SHALL BE QUOTED SEPRATELY

# FOR AT BSIP LUCKNOW

#TIME PERIOD 15 DAYS.

# WARRANTY ONE YEAR

# VALIDITY 180 DAYS.

# LOCAL OFFICE/SERVICE CENTER MANDATORY.

# COMPANY SHOULD HAVE SIMILAR WORK EXPERIENCE WITH CENTRAL GOVT./PUBLIC SECTOR ORGANIZATION

#COMPANY MUST HAVE ISO 9001, ISO 18000, ISO 14000 CERTIFICATIONS

Workstation-1500mm W x 600mm x 1500mm Wx 600 x 1350mm HT

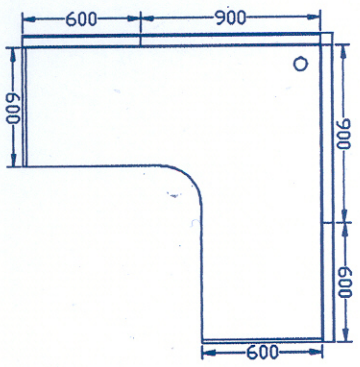

Top View

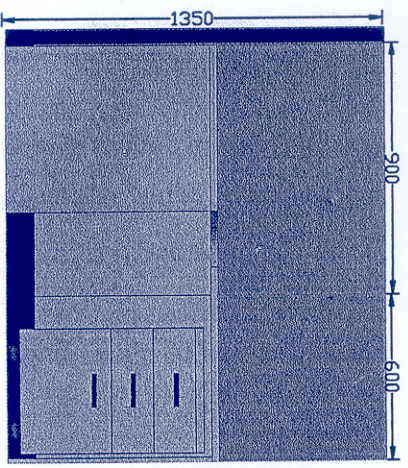

Front View

Isometric View

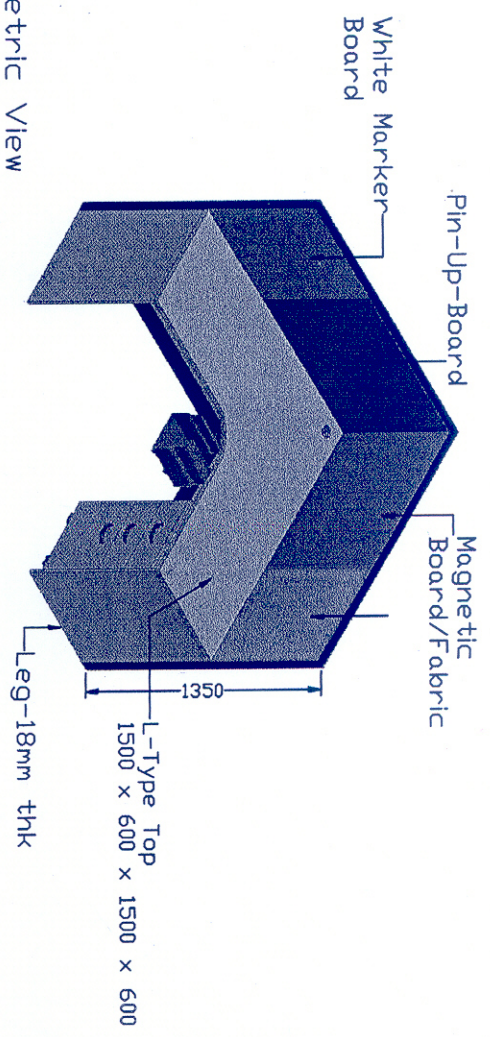

Isometric View

